

SCHEDULE "A"



J.E. ANDERSON & ASSOCIATES
SURVEYORS - ENGINEERS

TEL: 250-758-4631 FAX: 250-758-4660
NANAIMO - VICTORIA - PARKSVILLE

File: 87667

Civic: 6651 Aulds Road, Nanaimo, B.C.

SKETCH PLAN OF PROPOSED SUBDIVISION

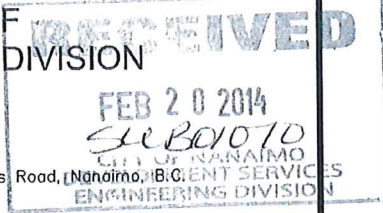

Legal: Lot 16, Section 8, Wellington District, Plan 24916.

Dimensions are in metres and are derived from Plan 24916.

This sketch does not constitute a redefinition of the legal boundaries hereon described and is not to be used in any matter which would assume same.

This sketch plan has been prepared in accordance with the Professional Reference Manual and is certified correct this 18th day of February, 2014.

This document is not valid unless originally signed and sealed

B.C.L.S.

© Copyright 2014 J.E. Anderson & Associates. All rights reserved. No person may copy, reproduce, transmit or alter this document in whole or in part without the consent of the signatory.

The signatory accepts no responsibility or liability for any damages that may be suffered by a third party as a result of any decision made, or actions taken based on this document.

Subject to charges, legal notations, and interests shown on: Title No. CA2247885 (P.I.D. 002-837-919)

Scale 1:500



**CITY OF NANAIMO
PRELIMINARY LAYOUT
ACCEPTANCE**

2014-MAY-26 *[Signature]*
Date Approved By

2015-MAY-26
Expiry Date

**RENEWAL
CITY OF NANAIMO
PRELIMINARY LAYOUT
ACCEPTANCE**

2015-MAY-07 *[Signature]*
Date Approved By

2016-MAY-26
Expiry Date

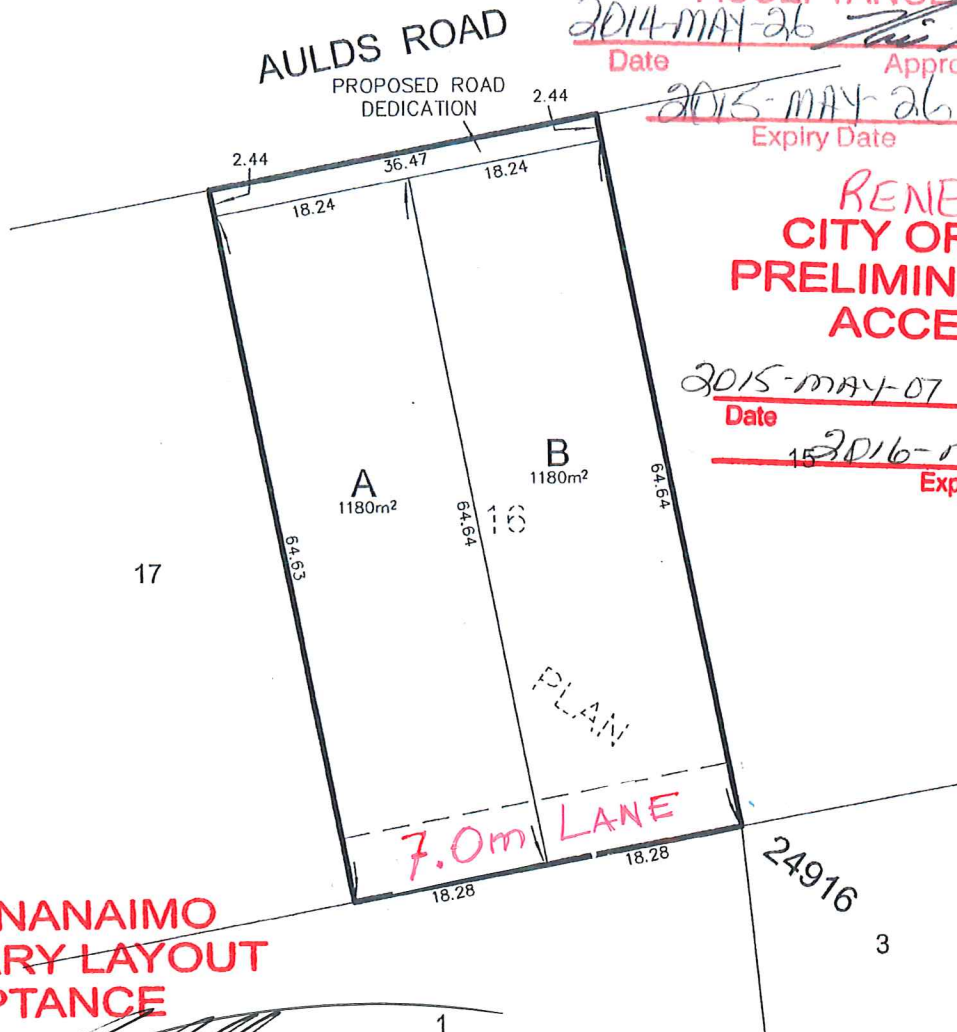

**CITY OF NANAIMO
PRELIMINARY LAYOUT
ACCEPTANCE**

2016-JUN-02 *[Signature]*
Date Approved By

2017-MAY-26
Expiry Date